

# DAMPER PARTS

## REGULAR QUADRANT



1. Heavy gauge plated steel/stainless steel
2. Positions locking with wing nut/knob
3. For use on square or round ducts

Part No.	Description	Damper Size
RQSH-M	5" long handle . 3/8" sq. Shaft hole	400mm
RQLH-M	6" long handle . 1/2" sq. Shaft hole	600mm
RQSH-I	5" long handle . 3/8" sq. Shaft hole	18"
RQLH-I	6" long handle . 1/2" sq. Shaft hole	30"

## HEAVY DUTY QUADRANT



1. Heavy gauge plated steel/stainless steel
2. Positions locking with wing nut/knob
3. For use on square or round ducts
4. Shaft lock feature eliminate damper rattle

Part No.	Description	Damper Size
HDQS-M	12.5mm Sq. spindle	30"
HDRR-M	12.5mm Round. spindle	30"
HDQS-I	1/2" Sq. spindle	30"
HDRR-I	1/2" Round. spindle	30"

## HEAVY DUTY QUADRANT LONG HANDLE



1. Heavy gauge plated steel/stainless steel
2. Positions locking with wing nut/knob
3. For use on square or round ducts
4. Shaft lock feature eliminate damper rattle

Part No.	Description	Damper Size
LHQR-M	12.5mm Sq. spindle	30"
LHQS-M	12.5mm Round. spindle	30"
LHQR-I	1/2" Sq. spindle	30"
LHQS-I	1/2" Round. spindle	30"

# DAMPER PARTS

## ULTRA LIGHT QUADRANT



1. Heavy gauge plated steel/stainless steel
2. Positions locking with wing nut/knob
3. For use on square or round ducts

Part No.	Description	Damper Size
LQS-M	8mm square spindle	20"
LQR-M	8mm round spindle	20"

## ULTRA LIGHT DUTY QUADRANT



1. Heavy gauge plated steel/stainless steel
2. Positions locking with wing nut/knob
3. For use on square or round ducts

Part No.	Description	Damper Size
ULQS-M	6mm Square spindle	400mm
ULQR-M	6mm Round spindle	600mm
ULQS-I	1/4" square spindle	12"
ULQR-I	1/4" round spindle	12"

## MINI QUADRANT



1. Heavy gauge plated steel/stainless steel
2. For use on square or round ducts

Part No.	Description	Damper Size
MNQS	Mini Quadrant with 1/4" end bearing	30"

# DAMPER PARTS

## MEDIUM QUADRANT



1. Heavy gauge plated steel/stainless steel
2. Positions locking with wing nut/knob
3. For use on square or round ducts

Part No.	Description	Damper Size
MDQS-M	5" long handle . 10mm sq. Shaft hole	400mm
MDRR-M	6" long handle . 12.5mm rnd. Shaft hole	600mm
MDQS-I	5" long handle . 3/8" sq. Shaft hole	18"
MDRR-I	6" long handle . 1/2" sq. Shaft hole	30"

## ELEVATED QUADRANT



1. Heavy gauge plated steel/stainless steel
2. Positions locking with wing nut/knob
3. For use on square or round ducts

### Quadrant for square duct (Part No.)

Quadrant ht.	1/4" handle	3/8" handle	1/2" handle
1"	EQS14-10	EQS38-10	EQS12-10
1.5"	EQS14-15	EQS38-15	EQS12-15
2"	EQS14-20	EQS38-20	EQS12-20

### Quadrant for round duct (Part No.)

Quadrant ht.	1/4" handle	3/8" handle	1/2" handle
1"	EQR14-10	EQR38-10	EQR12-10
1.5"	EQR14-15	EQR38-15	EQR12-15
2"	EQR14-20	EQR38-20	EQR12-20

# DAMPER PARTS

## END BEARINGS



Part No.	Sizes (AxB)	Part No.	Sizes (AxB)
SEB-01	1/4" X 1 -1/8"	SEB-05	3/8" X 2 -1/8"
SEB-02	1/4" X 2 -1/8"	SEB-06	3/8" X 3 -1/8"
SEB-03	1/4" X 3 -1/8"	SEB-07	1/2" X 1 -1/4"
SEB-04	3/8" X 1 -1/8"	SEB-08	1/2" X 2 -1/4"



Part No.	Sizes (AxB)
REB-01	1/4" X 1 -1/8"
REB-02	3/8" X 2 -1/8"
REB-03	1/4" X 3 -1/8"
REB-04	3/8" X 1 -1/8"



Part No.	Description
ZSS-01	Vav blade arm set



Part No.	Sizes (AxB)
SL - 01	1/4" X 2
SL - 02	1/4" X 3 -1/8"
SL - 03	3/8" X 2 -11/16"
SL - 04	3/8" X 3 -3/4"

# DAMPER PARTS

## SQUARE SPINDLES



Part No. (without holes)	Part no. (with holes)	Size
SS1 - I	SSWH1 - I	½"X5"
SS2 - I	SSWH2 - I	½"X3"
SS3 - I	SSWH3 - I	3/8"X5"
SS4 - I	SSWH4 - I	3/8"X3"
SS1 - M	SSWH1 - M	12.5"x125
SS2 - M	SSWH2 - M	12.5X75
SS3 - M	SSWH3 - M	10X125
SS4 - M	SSWH4 - M	10X75

## ROUND SPINDLES



Part No. (without holes)	Part no. (with holes)	Size
RS1 - I	--NA--	½"X5"
RS2 - I	--NA--	½"X3"
RS3 - I	--NA--	3/8"X5"
RS4 - I	--NA--	3/8"X3"
RS1 - M	--NA--	12.5"x125
RS2 - M	--NA--	12.5X75
RS3 - M	--NA--	10X125
RS4 - M	--NA--	10X75

## STRAP



1. MS Electro zinc plated
2. Available in various sizes
3. Used for damper

Part No.	Description
SLB-01	Strap

# DAMPER PARTS

## SHAFT LOCK LINKAGE



1. For use with round spindles
2. For linking two or more blades
3. Made of steel . electro galvanised

Part No.	Description
SLL - I	Shaft size 1/2"
SLL - M	Shaft size 12.5mm

## FLAT LINKAGE



1. For use with round & square spindles
2. For linking two or more blades
3. Made of steel . electro galvanised

Part No.	Description
FL1-I	Spindle size round 1/2"
FL2-I	Spindle size square 1/2"
FL1-M	Spindle size round 13mm
FL2-M	Spindle size 12.5mm

## FULL GEAR



1. For use with round & square spindles
2. For linking two or more blades
3. Made of engineering plastic

Part No.	Description	Pkt Qty
DGFL-01	Nylon gear 4" full circle	500nos.

## HEMI GEAR



1. For use with round & square spindles
2. For linking two or more blades
3. Made of engineering plastic

Part No.	Description	Pkt Qty
DGHL-01	Nylon gear 4" half circle	100nos.

# DAMPER PARTS

## PLASTIC BUSHES



Part No. (open)	Part no. (closed)	Product Description
PBS1 - I	CPBS1 - I	12.5mm square spindle
PBS2 - I	CPBS2 - I	10mm square spindle
PBS3 - I	CPBS3 - I	8mm square spindle
PBS4 - I	CPBS4 - I	6mm square spindle
PBS1 - M	CPBS1 - M	1/2" square spindle
PBS2 - M	CPBS2 - M	3/8" square spindle
PBS3 - M	CPBS3 - M	5/16" square spindle
PBS4 - M	CPBS4 - M	1/4" square spindle

## BRASS BUSHES



Part No.	Product description
BBS1 - I	12.5mm square spindle
BBS2 - I	10mm square spindle
BBS3 - I	8mm square spindle
BBS4 - I	6mm square spindle
BBS1 - M	1/2" square spindle
BBS2 - M	3/8" square spindle
BBS3 - M	5/16" square spindle
BBS4 - M	1/4" square spindle

# DAMPER PARTS

## ZINC LEVER



1. MAT: 16GA Steel galvanized

Part No.	Description	Pkt Qty
DZL01	Used in damper along with saddle & zinc screw	1000 Nos.

## RIGHT ANGLE LEVER



1. MAT: 20GA Steel galvanized

Part No.	Description	Pkt Qty
DRA01	Used in damper along with saddle & zinc screw	1000 Nos.

## SADDLE



1. MAT: 16GA Steel galvanized

Part No.	Description	Pkt Qty
DS01	Used in damper along with saddle & zinc screw	1000 Nos.

## ZINC SCREW



1. MAT: Zinc die cast

Part No.	Description	Pkt Qty
DZS01	Used in damper along with saddle & zinc screw	1000 Nos.

## DAMPER SCREW



1. MAT: Zinc die cast

Part No.	Description	Pkt Qty
DDS01	Used in damper along with saddle & zinc screw	1000 Nos.

## CAM



1. MAT: Aluminium

Part No.	Description	Pkt Qty
CAM01	CAMVV	1000 Nos.



# FIRE DAMPER PARTS

## CURTAIN BLADE



1. Used in curtain fire dampers
2. Precision Roll formed from G-90 material
3. Free movement
4. Available in speciality materials & finishes

Part No.	Description	Pkt Qty
CBLD01	70mm wide Mat: 0.8mm Galvanised steel , Stand. lenthgth 4m	48m
CBLD02	70mm wide Mat: 0.8mm Stainless steel , Stand. lenthgth 4 m	48m
CBLD03	50mm wide Mat: 0.8mm Galvanised steel , Stand. lenthgth 4 m	48m
CBLD04	50mm wide Mat: 0.8mm Galvanised steel , Stand. lenthgth 4 m	48m

## CURTAIN CLIPS



1. Used for fixing fusible links
2. Steel chrome plated

Part No.	Description	Pkt Qty
FLH-T1	Hook for fusible link	1000

## CURTAIN CLIPS



1. Used for fixing fusible links
2. Steel chrome plated

Part No.	Description	Pkt Qty
FLH-T2	Hook for fusible link	1000

# FIRE DAMPER PARTS

## CATCH PLATE

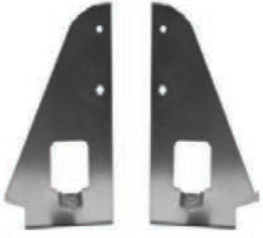

Part No.

Description

FDB-01

Fire damper bracket for holding SS spring.

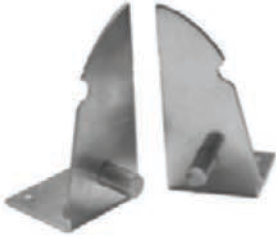

Part No.

Description

FDB-02

Fire damper bracket for holding SS spring.



Part No.

Description

FDB-03

Fire damper bracket for holding SS spring.



Part No.

Description

FDB-04

Fire damper bracket for holding SS spring.



Part No.

Description

FDB-05

Fire damper bracket for holding SS spring.

# AIR DUCT PARTS

## TM CORNER



1. Used for TDC duct work
2. Fixing hole for 3/8" carriage bolt
3. Available in different material & thickness

Part No.	Description	Qty/ Box
TDC-CS16-01	Corner for TDC flange 16GA galvanised steel	400Nos.
TDC-CS18-01	Corner for TDC flange 18GA galvanised steel	500Nos.

## CM CORNER



1. Used for TDC & TDF duct work
2. Fixing hole for 3/8" carriage bolt
3. Available in different material & thickness

Part No.	Description	Qty/ Box
CMC-CS16-01	Corner for TDC flange 16GA galvanised steel	400Nos.
CMC-CS18-01	Corner for TDF flange 18GA galvanised steel	500Nos.

## TF CORNER



1. Used for TDF duct work
2. Fixing hole for 3/8" carriage bolt
3. Available in different material & thickness

Part No.	Description	Qty/ Box
TDF-CS16-01	Corner for TDF flange 16GA galvanised steel	400Nos.
TDF-CS18-01	Corner for TDF flange 18GA galvanised steel	500Nos.

# AIR DUCT PARTS

## TM CORNER



1. Used for 25 mm slide on flange
2. Fixing hole for 5/16" carriage bolt
3. Available in different material & thickness

Part No.	Description	Qty/ Box
DM25-CS16-01	Corner for 25mm flange 5/16" bolt size	400Nos.
DM25-CS18-01	Corner for 25mm flange 5/16" bolt size	500Nos.



1. Used for 35 mm slide on flange
2. Fixing hole for 3/8" carriage bolt
3. Available in different material & thickness

Part No.	Description	Qty/ Box
DM35-CS16-01	Corner for 35mm flange 3/8" bolt size	400Nos.
DM35-CS18-01	Corner for 35mm flange 3/8" bolt size	500Nos.



1. Used for 45 mm slide on flange
2. Fixing hole for 3/8" carriage bolt
3. Available in different material & thickness

Part No.	Description	Qty/ Box
DM45-CS16-01	Corner for 45mm flange 3/8" bolt size	400Nos.
DM45-CS18-01	Corner for 45mm flange 3/8" bolt sizeT	500Nos.

# AIR DUCT PARTS

## CGI CORNER



1. Used for CGF01 duct work
2. Fixing hole for 3/8" carriage bolt
3. Available in 14GA SS galvanized/GP

Part No.	Description	Qty/Box
CGF1-C30	Two piece corner for CGF1 30mm flange	250Nos.
CGF1-C20	Two piece corner for CGF1 20mm flange	500Nos.

**\* CRIMPING TOOL REQUIRED FOR FIXING I- CORNER**

## CGL01 CORNER



1. Used for CGF01 duct work
2. Fixing hole for 3/8" carriage bolt
3. Available in 14GA SS galvanized/GP

Part No.	Description	Qty/Box
CGF1-L30	Corner for CGF1 - 30mm flange	400Nos.
CGF1-L20	Corner for CGF1 - 20mm flange	600Nos.

## CGL02 CORNER



1. Used for CGF01 duct work
2. Fixing hole for 3/8" carriage bolt
3. Available in 14GA SS galvanized/GP

Part No.	Description	Qty/Box
CGF2-L35	Corner for CGF2 & TDF - 30mm flange	400Nos.

# AIR DUCT PARTS

## CGI CORNER



1. Mat : Structural Steel galvanised
2. For use with all slide on flanges 20, 30, 40mm
3. Available in speciality material to meet flange mat
4. Meet SMACNA requirments
5. Packaging as per customer demand

Part No.	Description	Material type	Thickness (mm)	Reduction (mm)	Weight (kg/peice)
LCCS - 20	CR Corner	Galvanised steel	2.50	30	0.060
LCCS - 30	CR Corner	Galvanised steel	3.00	30	0.105
LCCS - 40	CR Corner	Galvanised steel	5.00	30	0.250
LCCA - 20	CR Corner	Aluminium	2.50	30	0.020
LCCA - 30	CR Corner	Aluminium	4.00	30	0.050
LCCA - 40	CR Corner	Aluminium	5.00	30	0.135

# AIR DUCT PARTS

## TEST PORT



Part No.	Description	Pkt Qty
DTP-01	Test port	100 Nos.

## G - CLAMP



Part No.	Description	Pkt Qty
DGC-01	G-Clamp	100 Nos.

## G - CLAMP



Part No.	Description	Pkt Qty
DGC-02	G-Clamp	100 Nos.

# AIR DUCT PARTS

## AV MOUNT



1. Natural rubber mount with 2 SS caps for equal load distribution
2. Deflection at full load 8 mm

Part No.	Description	Pt. Load
AVM-01	Vibration mount	90kg
AVM-02	Vibration mount	60kg

## AV MOUNT



1. Suitable for suspended Mechanical equipments
2. Deflection at full load 8 mm
3. Steel Powder Coated housing with Rubber element

Part No.	Description	Pt. Load
AVH-01	75X60X60mm	120kg
AVH-02	75X60X60mm	70kg



# AIR GRILL PARTS

## DIFFUSER STRIP



1. Made from 0.5mm thk precoated steel
2. 12mm sq punched
3. Pitch accuracy on entire length
4. 5 inch ID to meet spool holder

Part No.	Description	Roll qty
PSSB-32	Perforated Strip Black Colour 32mm width	250m
PSSB-36	Perforated Strip Black Colour 36mm width	250m
PSSB-42	Perforated Strip Black Colour 42mm width	250m

## EGG CRATE GRILL

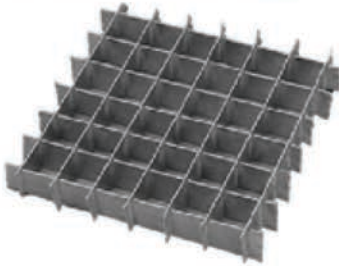

1. Aluminium Construction
2. Grid Size 1/2"x1/2"x1/2"
3. Used for various application

Part No.	Description
EGLV-01	1200x1200 (4'x4')
EGLV-02	600x600mm(2'x2')

## CORNER KEY



1. Material : 16ga Steel Galvanised / aluminium
2. Used at corner of square diffuser

Part No.	Description	Qty/Box
GC-CS-01	Corner for Diffuser mat steel galvanised	1000
GC-AL-01	Corner for Diffuser mat aluminium	1000

## RIGHT ANGLE CLIP



1. Material : SS or spring steel zinc plated
2. Used at corner of square diffuser

Part No.	Description	Qty/Box
RAC-CS-01	Right angle clip carbon steel	1000
RACC-AL-01	Right angle clip stainless steel	1000

# AIR GRILL PARTS

## DAMPER CLIP



1. Material : MS Chrome plated
2. Used for fixing damper with diffuser

Part No.	Description	Qty/Box
DS-01	Damper clip	1000

## CONCEALED CLIP



1. Material : MS Chrome plated
2. Used for fixing diffuser

Part No.	Description	Qty/Box
CC-01	Concealed clip	1000

## BUSH STRIP



1. Material : LDPE
2. Used for air grill & diffuser

Part No.	Description	Qty/Box
PBS-20	Bush strip for grills . 11 bushes Equally spaced at 25mm pitch	500 strips

## GRILL BUSH



1. Material : LDPE
2. Used for air grill & diffuser

Part No.	Description	Qty/Box
PBLC01	Bush strip for grills . Clear natural color	10000 nos.
PBLC02	Bush strip for grills . Blue color	10000 nos.

## ALUMINIUM PINS



1. Material : LDPE
2. Used for air grill & diffuser

Part No.	Description	Qty/Box
GPL-01	Aluminium pin long	5000 nos.
GPS-01	Aluminium pin short	5000 nos.

# AIR GRILL PARTS

## CAM LOCK



1. Used for pannel lock system

Part No.	Description	Qty/Box
ACL-01	Cam lock	250

## CAM LOCK



1. Used for pannel lock system

Part No.	Description	Qty/Box
OCL-01	Cam lock	250

## HINGES



1. Various Forms & sizes available  
2. Available in speciality materials  
3. Electro Zinc Plated

Part No.	Description
HLV-1	1 - 1/16" x 3" without punched hole
HLV-2	1 - 1/2" x 3" without punched hole
HLV-3	2" x 3" without punched hole
HLV-4	1 - 1/16" x 3" with hole
HLV-5	1 - 1/2" x 3" with hole
HLV-6	2" x 3" with hole

## FASTNERS



1. Various Forms & sizes available  
2. Available in speciality materials  
3. Eelectro Zinc Plated

Part No.	Description	Qty/Box
FLV-01	Fastners	200 nos.